

Client Information Pack

Thank you for choosing Ecoquip Hydraulic Pump jacks. The following pages are the information you and the completion crew need to ensure a quick and effective start-up of our equipment. Please review all information and do not hesitate to contact your Ecoquip representative with any further questions. Thank you.

Page 1: Pump Jack Information and Requirements

Page 2: Notes for the Completion Crew

Page 3: Wellhead Installation

Page 4: Set-up Procedure

Page 5: Additional Information

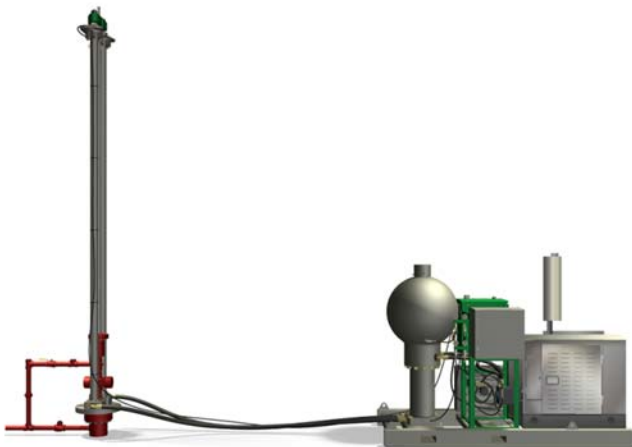



Pump jack information and Set Up Requirements

The Ecoquip Hydraulic Pump jacks are extremely portable and functional for all your pumping needs. If the wellhead and other site requirements are ready as per this information package, a crew of two can set up the equipment in approximately 2-3 hours.

Some notes about the unit:

- The power unit is built on a 10' X 4.5' skid and the area where the unit is placed should be level and preferably gravelled, but not necessary. Setting the unit on 2 (2" x 8" x 6') planks will keep the frame out of the base material, snow and water. The unit should be approximately 15' to 18' from the well head.
- The power unit weighs about 6,500 lbs. The picker (supplied by Leading Edge) should be capable of lifting 6,500 lbs. at a 20 foot range to place the power unit on the site. The picker is also needed to install the slave cylinders on the well head. The weight requirement is approximately 2,000 lbs at a 30 foot height range. The picker will require a man basket for our crew to access the top of the slave cylinders.
- Ecoquip Hydraulic Pump jacks are equipped with electric motors or gas engines which can run on propane, rich clean well head / casing gas or diesel. Please ensure your fuel or power supply is ready on the day of the set up. For propane, you will require a first stage regulator off the main tank, a 0 – 30 PSI gauge installed after the first stage regulator and the required length of hose to reach the equipment (est. 50' to 100') with ½" SAE female hose ends. If using wellhead gas please contact your Leading Edge representative. For electric motors, you will be required to have a starter unit or VFD capable of running the electric motor (Leading Edge will supply the motor requirements – normally a 50HP – 57 amp – 460 volt for the 9000-6 series or a 75HP – 67 amp – 460 volt for the 9000-9 series), a 110V - 2.8 amp supply cable from the starter to the controller cabinet and a dry contact loop cable from the starter to the controller cabinet to connect our low hydraulic oil shut down switch.
- Ecoquip Hydraulic Pump jacks use specific hydraulic fluids, oils and filters in their operation. Using the recommended hydraulic fluids and oils will avoid incompatibilities between the fluids and extend the run life of the equipment.
- Leading Edge will provide routine maintenance service on the equipment every 1,000 hours (during the entire rental period or during the warranty period for purchased equipment) to ensure a proper and consistent operation of the equipment.
- For set up, operation and take down or moving, service is done by Leading Edge. On our initial set-up, we take the time to train operators on how to use the equipment and maximize its performance. Operation manuals are left on the inside door of the controller cabinet. We are available at all times to answer questions or come to your site to assist in any activities in regards to our equipment.
- The well head needs to be set up as per the following diagram. Please note the 6" nipple above the tubing head, the ratigan and flow tees are on the same plane, there is a 10' polish rod stick up and our standard well head plates are for R-45 and R-46 12 bolt pattern tubing head flanges. If any of the above cannot be met, please contact us prior to set up.

Notes for the Completion Crew

Ecoquip Hydraulic Pumpjacks are easy to set up, but do require a few small modifications to the wellhead set-up.

- Install a minimum 4-6" long pipe nipple between the tubing hanger flange and the ratigan/BOP. We find on some wellheads that our slave cylinder mounting flange interferes with the hammer locks stems on the ratigan. Raising the BOP eliminates this interference.
- The ratigan stem and the production tee should be located parallel with one another.
- With the pump at the bottom of its travel, the polished rod should extend a minimum of 10' above the tubing bonnet flange, if this is not available, please advise Ecoquip and we can provide a stub rod to achieve the desired length.
- Do not tighten the pony rod on the polished rod, as it must be removed to install a rod retainer bushing during installation.
- Do not install the rod rotator, it will be installed by the Ecoquip field technician after the slave cylinders have been set.
- Please refer to the diagram to the right to ensure wellhead is set up correctly.
- In cases of wellheads with different specifications or requirements, or if you have any questions in regards to installation, please contact Leading Edge and we will ensure that we can adjust to your requirements or explain the proper steps to ensure a smooth installation.
- Leading Edge Office: 780-836-2445
- Bryan Shields: 780-836-5100
- Troy Shields: 780-836-6667

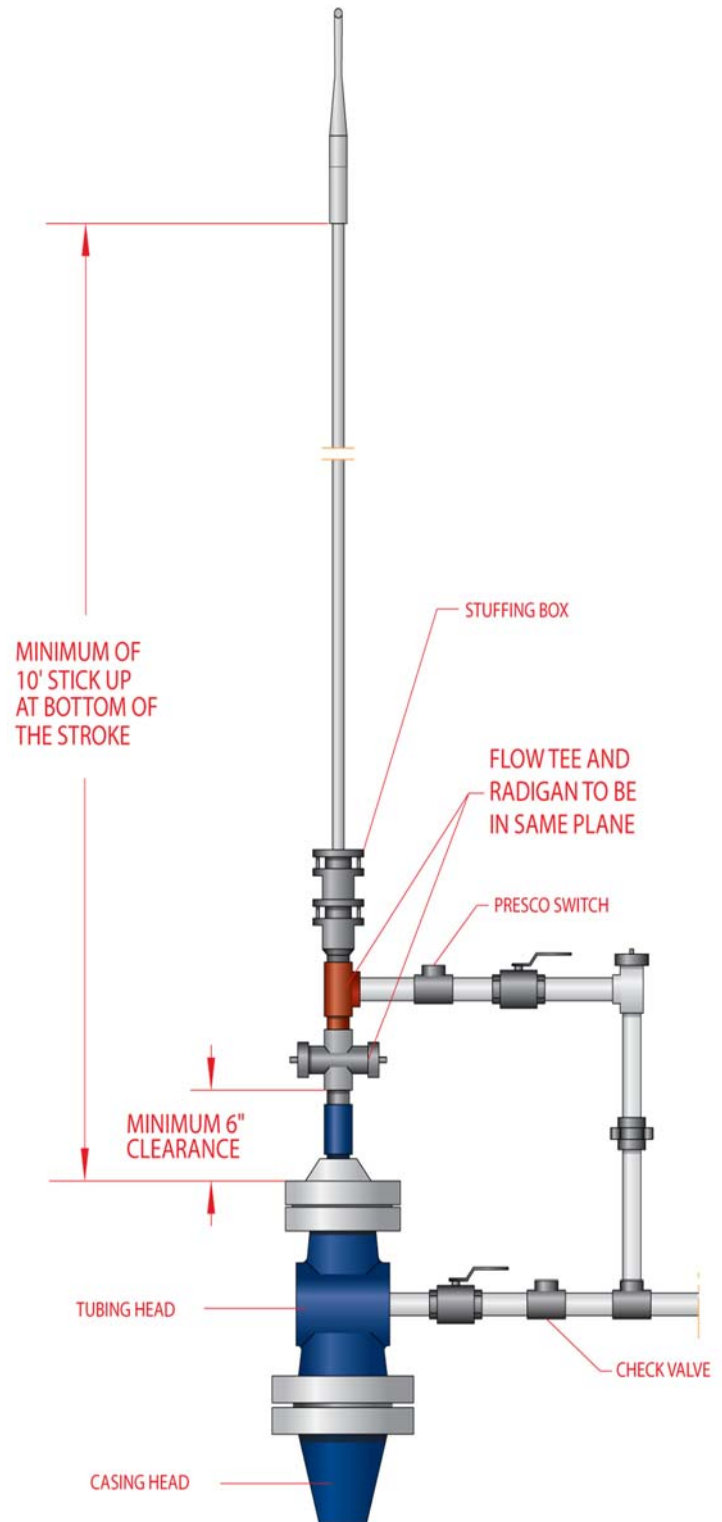

Wellhead Installation

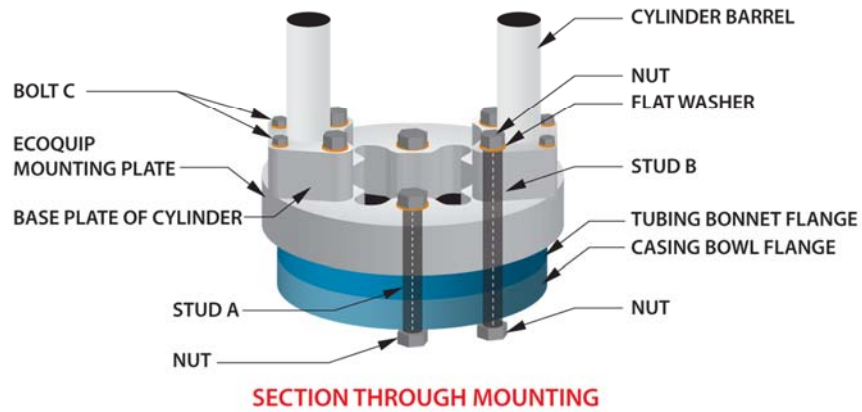
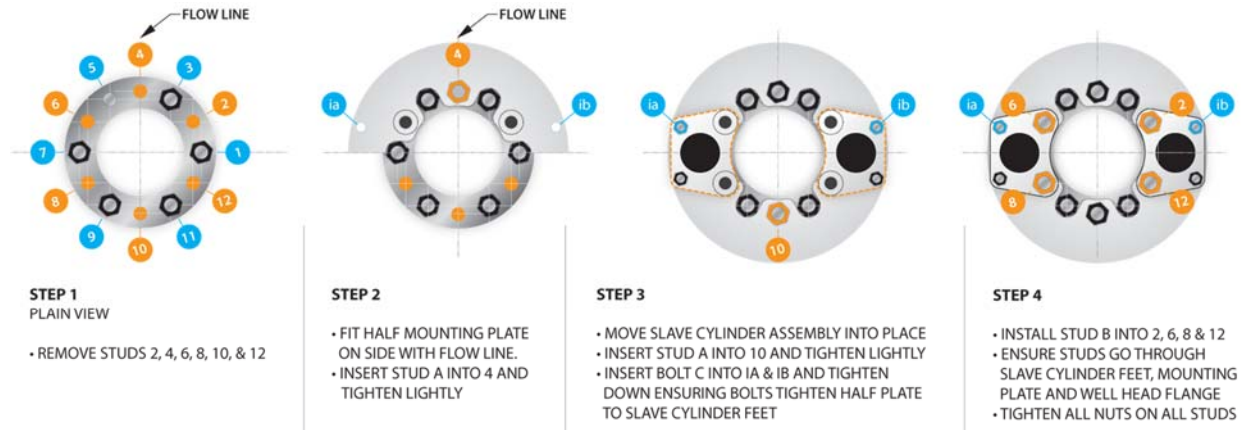

| WELLHEAD INSTALLATION | |
|---|---|
| 2000lb Well head: | Stud A- 1" x 11" Stud B – 1" x 15" |
| 3000lb Well head: | Stud A – 1-1/8" x 11" Stud B – 1-1/8" x 15" |
| 5000lb Well head: | Stud A – 1-3/8" x 15" Stud B – 1-3/8" x 18" |
| Bolt C for ia and ib: 1-1/4" x 5-1/2" Gr. 8 bolts | |

Set-up Procedure



- Installing the unit consists of two main steps. Setting the pumping unit by the wellhead and securing the slave cylinders on top of the wellhead
- To secure the slave cylinders to the wellhead, remove studs as instructed on page 4 -"Wellhead Installation"
- The slave cylinders have a two piece mounting plate. One half (not attached to the slave cylinder assembly) is placed on the side with the flow line. A single stud is placed in the centre as described. (shown at left)
- The slave cylinder assembly is then moved into position and the remaining studs are set into place and the bolts connecting the slave cylinder feet are tightened to the half plate.(shown at left)
- The large slave cylinder hoses are connected to the pumping unit and the feed line is connected to the reservoir. The unit is now ready to be started up.



Additional Information

Leading Edge provides set-up, ongoing support and training. We pride ourselves on service and know that you will be happy with our equipment and service.

At initial set-up, we will provide training, manuals and any other documentation you require to ensure smooth operation of our equipment. Our technicians are available to you and can either walk you through a solution over the phone or perform a service visit to your location. Our operation manual is also available for download on our website.

Preventive maintenance of the pump jack every 1,000 hours is critical to keep the hydraulic oil clean and to specification as this will avoid damages to the pump and master piston due to loss of lubrication properties and/or contamination of the oil.

After we get you started, we are available for any questions, consumables, parts or service work you need. Please do not hesitate to contact us at 780-836-2445

Contact Leading Edge for all your service and parts needed

SERVICES

Routine Maintenance and Equipment Inspection
Troubleshooting
Operation Training and Assistance
Equipment Repairs and Updating on site
Control System Software Updates
Seal Changes and Overhauls in our shop
Decommissioning/Relocations/Commissioning
Loaner Units Available

Original Parts

Manufacturers Approved SCHAEFFER Hydraulic and
Engine Oil
Filters and Luber Finer
Hydraulic Pumps
Automatic Oil Fillers
New and Refurbished Engine Packages
Engine Enclosures/Winter Grille Covers/Bug Screens
Electric Motors
Acoustic Doghouse and Noise Suppressant Mufflers